

Diff. Pressure Gauge for air series DPM.540

Applied to intergrated working environment
Pressure range of $\pm 50 \dots 5000 \text{ mmH}_2\text{O}$

General features

- Pressure ranges $\pm 50 \dots 5000 \text{ mmH}_2\text{O}$
- Accuracy ± 2.0 of Full Scale
- Non-contact type with magnet.
- Zero point adjustment can be easily by fine adjustment screw at front side.

Application area

- Check the air filter performance by measuring the differential pressure between both ends of the air filter.
- Measure flow by measuring the differential pressure between both ends of the pipe orifice.
- Measure differential pressure, reference pressure, vacuum and compound pressure of the various line.

General specification

Size

100mm

Pressure range

$\pm 50 \dots 5000 \text{ mmH}_2\text{O}$

Static pressure

Max. Pressure: 0.1MPa

Accuracy

± 2.0 of Full Scale

Temperature

operating temperature ranges
(ambient and measured medium)
 $-10 \dots +60^\circ\text{C}$

Case and Cover

ADC
(Aluminium Die Casting)

Type of mounting

Panel Attachment Bracket Type

Case filling

Dry

Process Connection

Material: Brass
NPT1/8"(female)



Differential pressure gauge, series DPM.540

Element(Diaphragm)

Silicon Rubber, NBR

Dial

Aluminium

Window

Poly Carbonate

Summary

- DPM.540 is suitable for differential pressure measurement between low and high pressure of air. This differential pressure value from the DPM5 could be used for level and flow measurements.

Safety Management

- DPM.540 needs the protective device in vibration, pulsation and rapid pressure changes.
- The gauge can be damaged if there is an impact during using, moving and installing.
- It should be installed horizontal or vertical.
- Excess of static pressure or operating temperature can cause damage.
- Use the high pressure inlet & low pressure inlet as the location marked in product.



DAHO Tronic Limited

Tel: 02-865-7001 Fax: 02-865-7109

mail: info@daho.co.kr

STX W-Tower 209

Gyeongin-ro 53 Gil 90 Guro-gu

Seoul 08215 Korea

www.daho.co.kr

Ordering Information

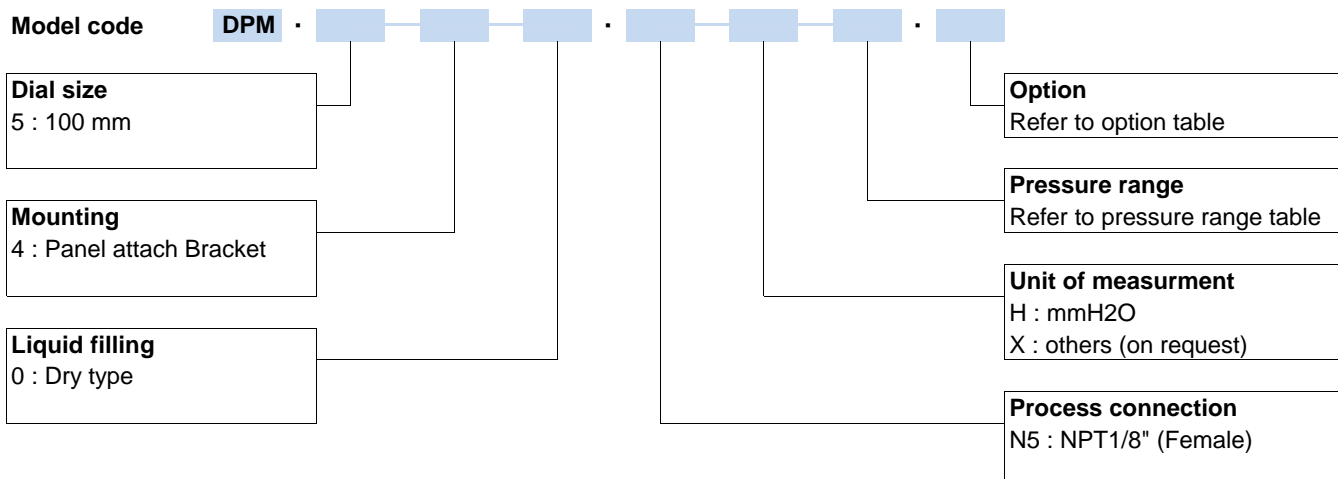

Pressure range code, unit bar

Code	Range
R101	-50...50 mmH ₂ O
R103	-150...150 mmH ₂ O
R105	-250...250 mmH ₂ O
R106	-500...500 mmH ₂ O
R116	-1000...1000 mmH ₂ O
R117	-1500...1500 mmH ₂ O
R119	-2500...2500 mmH ₂ O
R120	-3000...3000 mmH ₂ O
R123	0...50 mmH ₂ O
R124	0...100 mmH ₂ O
R127	0...300 mmH ₂ O
R129	0...500 mmH ₂ O
R131	0...1000 mmH ₂ O
R134	0...2000 mmH ₂ O
R136	0...3000 mmH ₂ O
R138	0...5000 mmH ₂ O
YY	Others

How to Order

DPM.540.R5HR121

DPM, 100mm, Cl. 2.0% of FS, Panel attach. Bracket, Dry, NPT 1/8"(F), 0...300 mmH₂O

Outline drawing

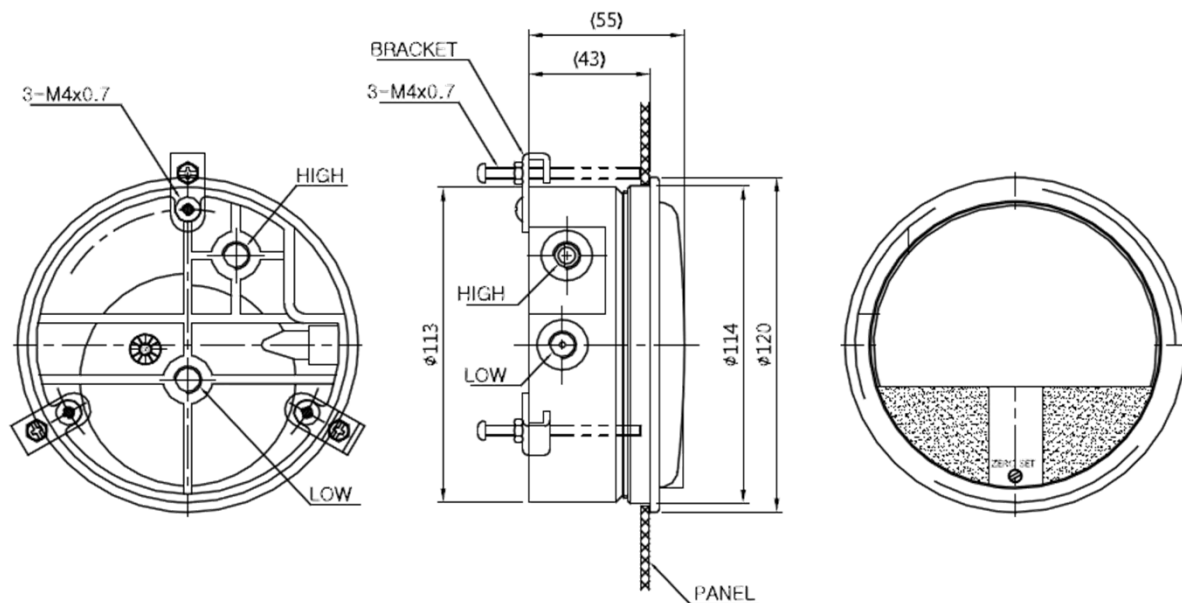

Application Sample

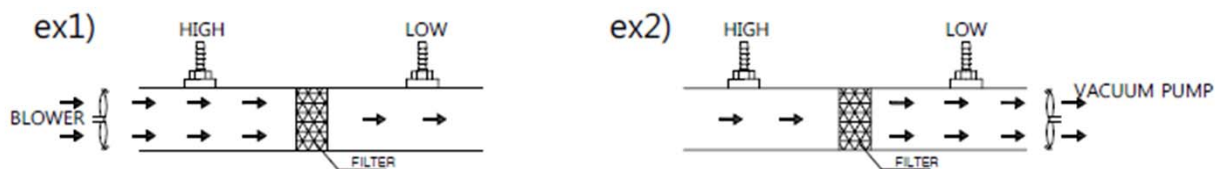

DAHO

Daho Tronic Ltd.

STX W-Tower 209

Gyeongin-ro 53Gil 90 Guro-gu

Seoul 08215 Korea

Tel: +82 2 865-7001 Fax: +82 2 865-7109

info@daho.co.kr

www.daho.co.kr